

GRIPPEX® II SMALL

Powerful Automatic Bar Puller for Small CNC Lathes

- STATIONED AT THE TURRET
- DRIVEN BY COOLANT
- CONTROLLED BY THE NC-PROGRAMME



GRIPPEX® II is the Bar Puller that makes your CNC-Lathe more effective, right away!

For various reasons, such as high costs or limited floor space in work shops, a small percentage only of the CNC-Lathes are equipped with some kind of magazine-type bar feeder. In small-batch production, however, the machine spindle itself, in addition with its inserted guiding tube and GRIPPEX, provides you with a simple and highly efficient Bar-Feeder.



Grippex® II Small.
Patent Pending & Design Patent Pending.

A new way to work

Please, imagine that 40 workpieces of 20 mm length each may be automatically machined from a single one meter bar!

- Make GRIPPEX do it for you! 40 workpieces in unmanned production!

Supposing that the machining cycle time is 1 minute. Then GRIPPEX gives you 40 spare minutes for better use than pulling the bar manually or handling small pieces of cut raw material.

- You'll find yourself with a lot of spare time for other operation such as quality checks and/or making preparations for the next batch work etc.

Here's how it works

Programming method

- Calling the turret tool post holding the GRIPPEX Bar Puller.
- Positioning of GRIPPEX in X- and Z-axes.
- Coolant ON for GRIPPEX clamp.
- Chuck unclamp.
- Pulling-out the bar and exact positioning in Z-axis according to the programme.
- Chuck clamp.
- Coolant OFF for GRIPPEX unclamp.
- Return to Zero and calling first tool.

Grippex advantages

- Instant setup - gripping is secured without any adjustment within the whole gripping range.
- Compact and light - Adjacent turret tool positions need not be vacated
- Powerful - stands high pressure - 15 bar. No need for a pressure reduction valve.
- Grippex doesn't need high pressure for pulling properly.
- It's working from 0.5 bar onward (see the power diagram on next page)
- Clamps very close to the chuck, allowing for short overhang of the bar.
- Clamps hexagon bars without need for spindle orientation.

OUTSTANDING PERFORMANCE

Specifikations

GRIPPEX® II SMALL

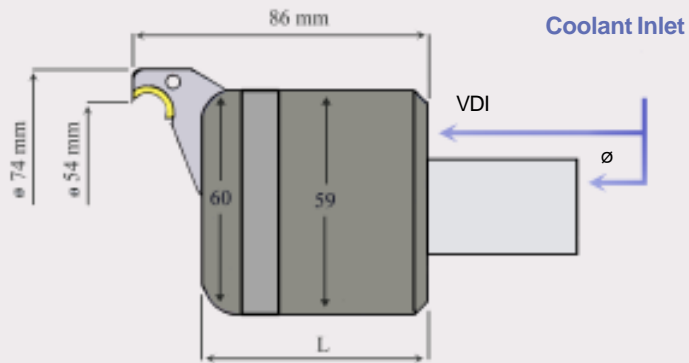

L

Straight shank	Directly fitted on the back plate	64 mm
VDI20,VDI25	Directly fitted on the back plate	64 mm
VDI30	Back plate VDI (L+11.80)	75.80 mm

Pulling Force Graph

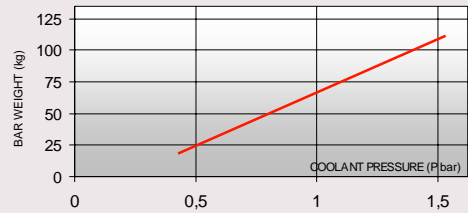

The graph shows the max. allowable weight of a mild steel bar to be pulled at a coefficient of friction valued <0.2

Grippex II Small stands high pressure - 15 bar

Available shanks

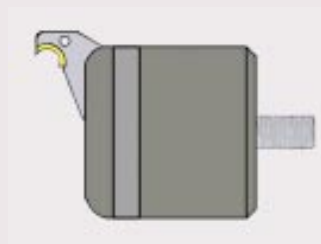

Straight $\varnothing 20, \varnothing 25, \varnothing 32$ mm

VDI20, VDI25, VDI30

Straight $\varnothing 1", \varnothing 1-1/4", \varnothing 1-1/2"$

ORDER CODE	DESCRIPTION
GPX-IIS/D20	Grippex II S with $\varnothing 20$ mm straight shank
GPX-IIS/D25	Grippex II S with $\varnothing 25$ mm straight shank
GPX-IIS/D32	Grippex II S with $\varnothing 32$ mm straight shank
GPX-IIS/VDI20	Grippex II S with VDI 20 shank
GPX-IIS/VDI25	Grippex II S with VDI 25 shank
GPX-IIS/VDI30	Grippex II S with VDI 30 shank
GPX-IIS/1"	Grippex II S with 1 inch shank
GPX-IIS/1-1/4"	Grippex II S with 1-1/4 inch shank
GPX-IIS/1-1/2"	Grippex II S with 1-1/2 inch shank

Gripping fingers



2-52 mm

ORDER CODE	DESCRIPTION	CAPACITY
GPX-IIS/F52*	Grippex II S Gripping fingers	2-52 mm

*) Order set contains three fingers

Inserts and Adapters



Inserts

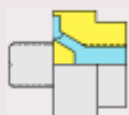

Adapter

ORDER CODE	DESCRIPTION
GPX-IIS/IF*	Grippex II S Inserts
GPX-II/AD	Grippex II Adapter for lathes without internal coolant supply

*) Order set contains three fingers

Distributed by:

MPC MPC Automation Systems AB
Box 5879, S-102 40 Stockholm, Sweden
Phone: +46 8 6670950 Fax +46 8 6670952

Visit us at <http://www.barpuller.com>